

## ACCURPRESS OFFERS...

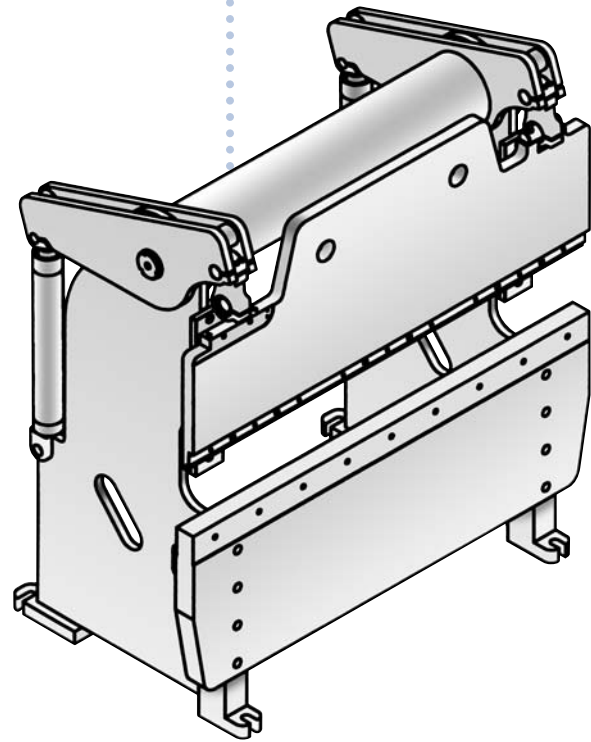

### UNIQUE DESIGN

Thousands of satisfied Accurpress customers throughout North America is a testament to the fact that the unique and simple design of the Accurpress is one of integrity and one that works for the long-term. This basic design consisting of side frames, bed assembly, ram, double rocker arm assembly and torque tubes has been tried and proven in a vast number of shops ranging from high precision sheet metal to heavy fabrication applications.

All sections are sized and engineered in accordance to the tonnage of the press brake to realize the ultimate in rigidity and durability. Every piece is meticulously machined and fitted to exact standards. The rear mount cylinders, attached to the double rocker arm assembly, allows for a compact frame with minimal side frame stress and the added advantage of an overall machine height considerably less than other press brake designs.

### ADAPTABLE DESIGN

Accurpress design is adaptable to customer's requirements such as a special bed and ram machining to suit specific tooling requirements, ram clamping options, higher ram open heights, punching applications and concentrated high tonnage loads.

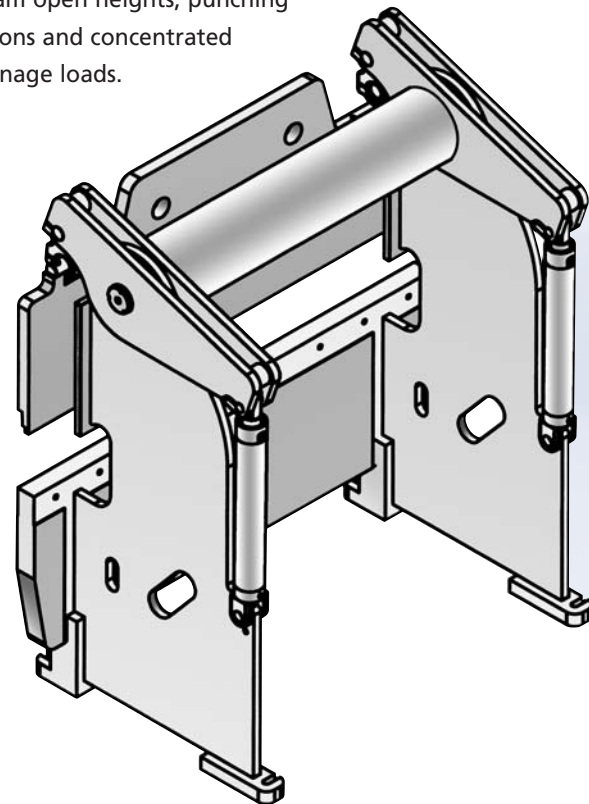

### POWER RAM TILT

The power ram tilt adjustment optimizes ram trim to match various tooling characteristics, or for doing fade out work. It is easily adjusted via push buttons located on the operator control stations. An eccentric shaft running through the left side connectors rod of the Accurpress will rotate when powered, and will tilt the ram to the desired location.



### MAINTENANCE FREE BEARINGS

Longevity, no lubrication service and highest quality is produced via precision ram gibbings and bearings purchased from world leaders in this industry. The ram is guided by heavy-duty slideways on chromed guide bars using lifetime, non-metallic pre-lubricated bearing inserts. The slideways are easily field adjustable for precision slideways bearing preload.

Virtual zero clearances are achieved via careful and specific bearing installation procedures. The main pivot points of the rocker assembly utilize high quality, maintenance free, self-lubricating plain bearings, and self-aligning spherical bearings. Both bearing types are sized in relation to the Accurpress model tonnage and are well suited to the high loads an oscillating motion of the press brake.

Decades of maintenance free bearing use can be expected via the self-lubricating feature. a unique application of polytetrafluoro-ethylene that greatly reduces the chance for premature failure.

## RELIABILITY & LONGEVITY

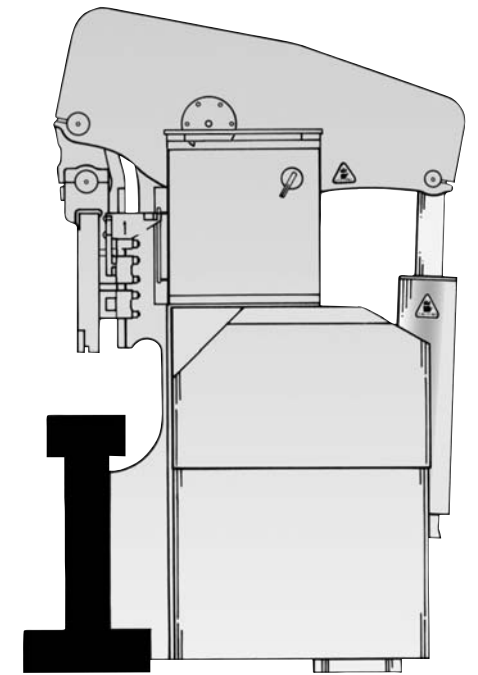

### FLUSH FLOOR MOUNT

The heavy I-beam design on larger Accurpress models greatly reduces bed deflections to achieve optimum forming quality and eliminates the need for below-the-floor bed members on models up to 600 ton capacities, except for few smaller tonnage models of twenty foot and above lengths.

Under load, all press brake bed and rams will be subject to some deflection resulting in the need for crowning die holders systems or shimming of tooling.

While some manufacturers produce flat bed and rams resulting in excessive shimming or die holder crowning requirements, the Accurpress bed and ram is engineered and machined with a small crown to minimize either shimming or die holder crowning in order to produce quality formed parts.